

## Construction Review Services Has Moved

Washington State Department of Health  
Construction Review Services  
111 Israel Rd SE, MS: 47852  
Tumwater, WA 98501  
Phone: (360) 236-2944 - Fax: (360) 236-2901

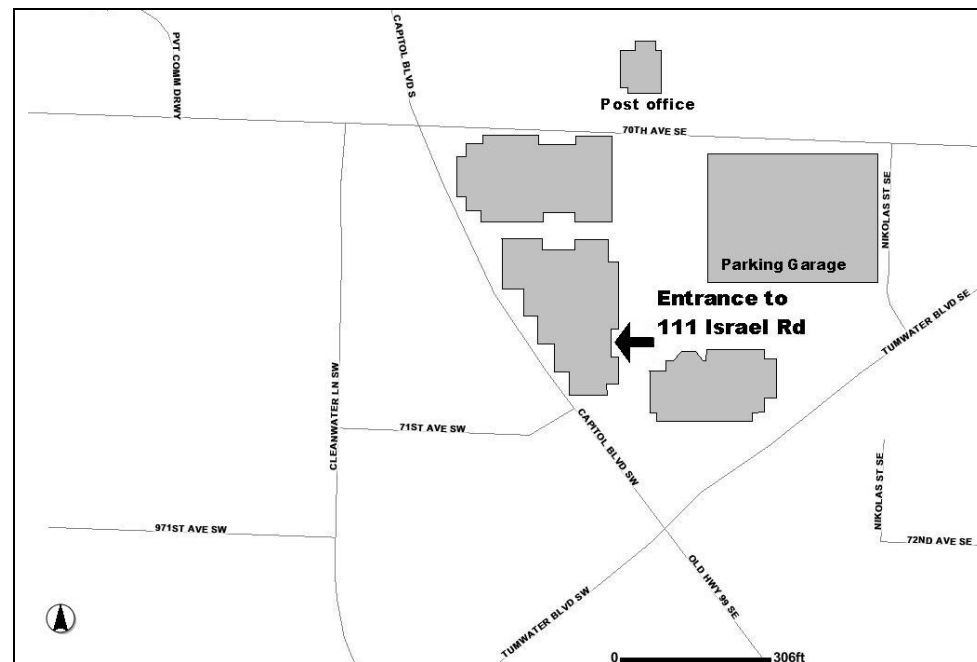

If you are traveling SOUTH on I-5 (from Seattle or Tacoma)

1. Take I-5 South to Exit 101 (not Highway 101 – Ocean Beaches)
2. Turn left at the stop light onto Tumwater Boulevard. Stay in the right hand lane.
3. Pass thru the round - about
4. Go 1 mile from I-5 and turn left on to Capitol Boulevard.
5. Move to the right lane and turn right on to Israel Road.
6. After the US Postal office, turn right into the parking lot.
7. CRS is located in Town Center East 2. (the middle building)

If you are traveling NORTH on I-5 (from Portland or Centralia)

1. Take I-5 North to Exit 101
2. Turn right at the stop light onto Tumwater Boulevard. Stay in the right hand lane.
3. Pass thru the round - about
4. Go 1 mile from I-5 and turn left on to Capitol Boulevard.
5. Move to the right lane and turn right on to Israel Road.
6. After the US Postal office, turn right into the parking lot.
7. CRS is located in Town Center East 2. (the middle building)

There is limited parking in front of the building. There is ample parking in the parking garage.